

# THE PERFECT HEAT





# OBSESSED WITH GRILLING

Handcrafted for real cooks, DCS Grills smoke, sear, rotisserie, bake and slow cook for all-round exceptional cooking performance. Match your skill with the ultimate in outdoor grilling. Combine with a full range of outdoor components to create your ultimate outdoor kitchen.



# PERFECTING THE ART OF GRILLING SINCE 1989

A tradition founded in Surf City, Huntington Beach, California, quickly gathered popularity across the American continent. Taking the outdoor lifestyle, the sound of sizzling, the aroma of smoke and the gathering of friends and family, DCS embodies the great outdoors legacy.

Building on a heritage of commercial quality appliances, DCS pioneered a new category in outdoor cooking—going beyond conventional barbecues. The series was conceived as a complete professional outdoor kitchen.

TAKE CHARGE OF YOUR TOOLS.  
SELECT THE BEST CUT.  
MASTER THE TEMPERATURE.  
CHOOSE YOUR METHOD.  
CONTROL THE HEAT.  
COAX OUT THE FLAVORS.  
SEASON TO TASTE.



## SEAR

**The perfect sear means a crisp, well-browned exterior with a tender and juicy interior whether fish, poultry, meat or vegetables.**



## ROTISSERIE

**An ideal rotisserie produces tender, juicy meat  
with the entire surface golden and crisp.**





## SAUTÉ

**Sautéing on the side burner is like pan frying on the grill. It creates opportunities for a wide range of recipes requiring medium to high heat.**



## SMOKE

**Smoking imbues flavor right through your food and can turn almost any cut of meat into something special. Use different woods for different flavors.**



## CHARCOAL GRILL

**Charcoal grilling gives you a juicy result with a subtle barbecue flavour.**



## BRAISE

**Flawless slow cooking comes from consistent, indirect heat over a long period of time — so meat will pull off the bone.**



## WARM AND BAKE

**Baking is easy with dependable temperature control allowing breads to rise and bake evenly.**



# PERFECT RESULTS

From slow and low to smoky and seared, rotisserie basted or charred and tender, DCS Grills do it all.

# BEAUTIFUL TO USE

We believe it's the small details that make the grilling experience easier, safer, healthier and more enjoyable. Enjoy grilling every day.

# BUILT TO LAST

When a grill is Built to Last, from the materials to the craftsmanship, every piece is considered not just for performance and aesthetics, but for ultimate durability to give you a lifetime of grilling.

# PERFECT RESULTS



## Charcoal Grilling and Smoking

Smoking imbues flavor right through your food while charcoal grilling will give you a juicy result with a subtle barbecue flavor. Have it all with Gas, Charcoal and Smoker all-in-one in the Series 9 Grill. Enjoy smoky barbecue flavor with the ease of instant gas flame ignition. Grill directly on the cooking grate or add wood chips for more smoke. A W-shaped tray with adjustable vents helps the charcoal last longer.

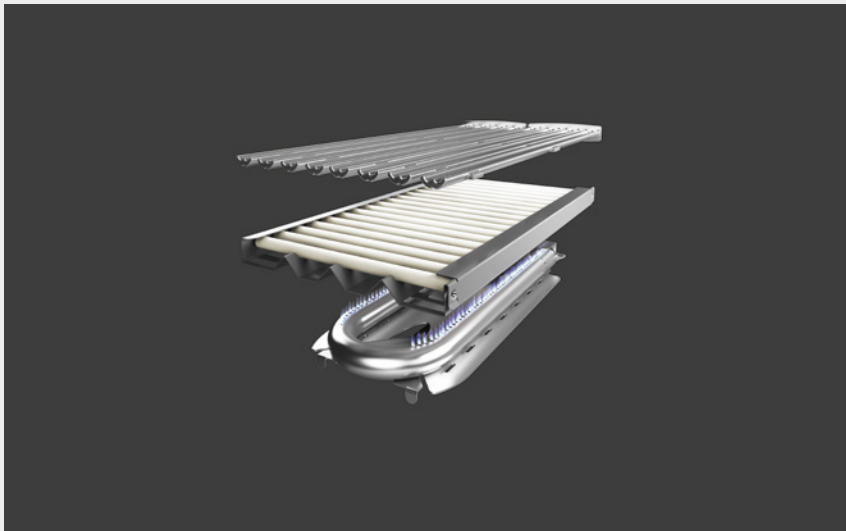

## Searing

Perfectly seared meat achieves a crisp, well-browned exterior with a tender and juicy interior, whether fish, poultry, meat or vegetables. DCS delivers exceptional searing across the full surface, with a powerful 25000 BTU output rating from each burner. DCS's unique ceramic rod design evenly distributes this heat so there are no uneven hot spots or cold patches.



25K  
BTU Burners



18K

BTU Searing Heat

50 lbs

Rotisserie  
Capacity



#### Rotisserie

Rotisserie cooking delivers tender, juicy meat with the entire surface golden and crisp. An infrared rotisserie burner provides controlled searing heat up to 18,000BTU that can easily handle meat weighting up to 50 pounds. Design details like the tuck-away rotisserie rod holder partner practicality with performance.



#### Braising, Baking and Warming

Good slow cooking gives you consistent, indirect heat over a long period of time, so breads rise evenly, and meat will pull off the bone.



The Series 9 Grill features controlled heat with an accurate temperature gauge (ranging from 300°-1100°F), ideal for slow cooking to searing, direct and indirect heat. The two racks and one broiling pan can be easily moved to provide a secondary cooking space, giving you flexibility to cook almost anything in addition to traditional grilling, from cornbread to baked beans.

# BEAUTIFUL TO USE



## Grease Management System

Control of dripping grease is essential for delivering perfect results as well as easy cleaning. Avoid flare ups with DCS's patented Grease Management System which channels oil away from the flame giving you greater control and better cooked food.



## Easy Lifting Hood

Grilling should be for everyone, so lightening the load of the solid stainless-steel hood makes the outdoor kitchen more accessible. With more space under the hood for extra-large food items, the spring assisted hood can be smoothly opened, using one hand, for better access and visibility when cooking. When opening the hood, its curvature directs heat and smoke away from you.



## Easy Cleaning

To really enjoy your grill, hygienic and simple cleaning is essential. It ensures you are set up for perfect grilling and optimum flavor. Turn on the heat to sear for 15 minutes before you start cooking and all residue will be burnt off, leaving your cooking surface clean with almost no effort. DCS Grills feature a removable drip pan, conveniently located in a slide-out tray to allow for easy cleaning.

12V

Hood Lighting



#### Intuitive Lighting

Good lighting helps you see what you are cooking, to achieve the perfect result. In the Series 9 Grill, dial lights make grilling safer by alerting you when the gas is on. See exactly what you're cooking, even at night with brilliant 12-volt hood lighting safely illuminating the whole grill. Bezel lighting on dials glow white when the lights or grill are on, and orange when the gas and grill are working.

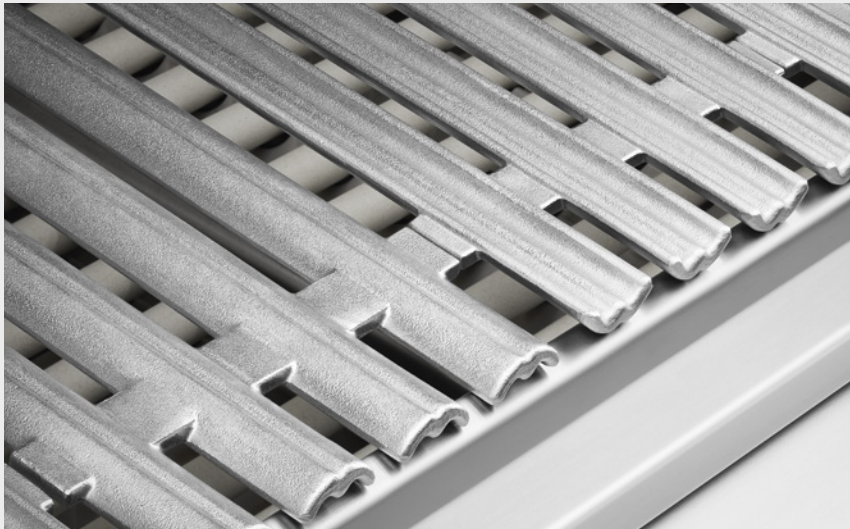

#### Double-Sided Cast Stainless Steel Grates

Robust sear lines need a solid grate, but equally delicate foods like fish need a different surface for searing. Double-sided cast stainless steel grilling grates have a gentle radius for handling delicate foods. The other side is W-shaped for perfect sear lines while channelling oil away to the multi-position drip tray.



# BUILT TO LAST



## Lifetime Warranty

**A Premium Grill should be with you for life. The warranty should support that. DCS Grills come with class leading lifetime warranty on: Stainless steel grill burners, Stainless steel grill cover, Burner box, Cooking grates, Grill Racks. A 5 year warranty applies to: Radiant Trays, Radiant Tray side Rails and the Drip Pan. 2 years full coverage warranty applies for parts and labour on the entire product.**

100%

Stainless Steel



**100% Stainless Steel**

**Real, solid, hardwearing and hand-finished materials are tangible elements of product quality. Built from heavy duty 304 stainless steel, inside and out, DCS Grills are built to handle anything Mother Nature can throw at them. All welded joints are hand-finished to deliver a premium finish and quality assurance.**







# SERIES 9 GRILLS



Handcrafted for real cooks, the DCS Series 9 Grill delivers exceptional cooking performance. Designed for unparalleled functionality and power and hand-finished to a high standard, these grills are built to withstand the demands of the serious cook and the weather, 365 days a year.



- 1 Easy lifting hood
- 2 Intuitive lighting
- 3 Braising, baking and warming
- 4 Rotisserie
- 5 Charcoal grill and smoker
- 6 Double-sided cast stainless steel grates
- 7 Full surface searing
- 8 Grease Management System™
- 9 100% stainless steel
- 10 Easy cleaning
- 11 Lifetime warranty\*









# SERIES 7 GRILLS



DCS Series 7 grills offer power, simplicity and control, giving you perfect results whether a premium steak or a delicate fillet of fish.

Built from 304 grade stainless steel and delivering 25,000BTU/hr of power, these Grills combine premium styling with thoughtful design to deliver powerful performance and flexible grilling solutions.



- 1 100% stainless steel
- 2 Rotisserie
- 3 Double-sided cast stainless steel grates
- 4 Full surface searing
- 5 Grease Management System™
- 6 Smoker box
- 7 Easy cleaning
- 8 Lifetime warranty\*



# GRILLS



**Series 9 Evolution Grills and Countertop Storage**

**PRODUCT**

**SKU (NATURAL / LP)**

**TYPE OF APPLIANCE**

**Product Dimensions**

**Cut-out Dimensions (proud installation)**



**BEI-48RC**

**71328 / 71329**

**48" Evolution Grill**

**H27 1/4" x W47 15/16" x D26 7/8"**

**H10 1/8" x W45 3/4" x D22 3/4"**



**BEI-36RC**

**71330 / 71331**

**36" Evolution Grill**

**H27 1/4" x W35 15/16" x D26 7/8"**

**H10 1/8" x W34 1/2" x D22 3/4"**



**ASE6-48**

**71405**

**6" Countertop Storage - 48" Evolution Grill**

**H11 13/64" x W7 23/32" x D26 7/8"**

**H10 1/8" x W52 1/8" x D22 3/4"**



**ASE6-36**

**71332**

**6" Countertop Storage - 36" Evolution Grill**

**H11 13/64" x W7 13/32" x D26 7/8"**

**H10 1/8" x W40 1/2" x D22 3/4"**

**Series 7 Grills**

**PRODUCT**

SKU (NATURAL / LP)

TYPE OF APPLIANCE

Product Dimensions

Cut-out Dimensions (proud installation)



**BH1-48R**

71299 / 71330

48" All Grill

H24 1/4" x W47 7/8" x D26 5/8"

H10 1/8" x W45 3/4" x D22 3/4"



**BH1-48RS**

71297 / 71298

48" With Integrated Side Burners

H24 1/4" x W47 7/8" x D26 5/8"

H10 1/8" x W45 3/4" x D22 3/4"



**BH1-36R**

71301 / 71302

36" All Grill

H24 1/4" x W35 7/8" x D26 5/8"

H10 1/8" x W34 1/2" x D22 3/4"



**BH1-30R**

71303 / 71304

30" All Grill

H24 1/4" x W30" x D26 5/8"

H10 1/8" x W28 1/2" x D22 3/4"



**BGC30-BQ**

71123 / 71124

30" All Grill, Non Rotis

H24 1/4" x W30" x D26 5/8"

H10 1/8" x W28 1/2" x D22 3/4"



**Countertop Storage, Liberty Grills, Hybrid Infrared Burner and Griddle Plate**

**PRODUCT**

**SKU**

**TYPE OF APPLIANCE**

**Product Dimensions**

**Cut-out Dimensions (proud installation)**



**ASH6-48**

**71406**

**6" Countertop Storage - 48" Series 7 Grill**

**H11<sup>3</sup>/<sub>64</sub>" x W7<sup>49</sup>/<sub>64</sub>" x D26<sup>41</sup>/<sub>64</sub>"**

**H10<sup>1</sup>/<sub>8</sub>" x W52<sup>1</sup>/<sub>8</sub>" x D22<sup>3</sup>/<sub>4</sub>"**



**ASH6-36**

**71333**

**6" Countertop Storage - 36" Series 7 Grill**

**H11<sup>3</sup>/<sub>64</sub>" x W7<sup>3</sup>/<sub>8</sub>" x D26<sup>41</sup>/<sub>64</sub>"**

**H10<sup>1</sup>/<sub>8</sub>" x W40<sup>1</sup>/<sub>2</sub>" x D22<sup>3</sup>/<sub>4</sub>"**

**PRODUCT**

**SKU (NATURAL / LP)**

**TYPE OF APPLIANCE**

**Product Dimensions**

**Cut-out Dimensions (proud installation)**



**BFGC-30G**

**71125 / 71126**

**30" Liberty All Grill**

**H10<sup>1</sup>/<sub>2</sub>" x W30" x D26<sup>5</sup>/<sub>8</sub>"**

**H10<sup>1</sup>/<sub>8</sub>" x W28<sup>1</sup>/<sub>2</sub>" x D22<sup>3</sup>/<sub>4</sub>"**



**BFGC-30BGD**

**71127 / 71128**

**30" Liberty Side Burner/Griddle**

**H10<sup>1</sup>/<sub>2</sub>" x W30" x D26<sup>5</sup>/<sub>8</sub>"**

**H10<sup>1</sup>/<sub>8</sub>" x W28<sup>1</sup>/<sub>2</sub>" x D22<sup>3</sup>/<sub>4</sub>"**

**PRODUCT**

**SKU**

**TYPE OF ACCESSORY**

**DESCRIPTION**



**BGC-IR**

**71409**

**Grill Surface Hybrid Infrared Burner**

The DCS Infrared Hybrid Burner delivers rapid heat-up with precise control of the heat turn-down, allowing great flexibility with what foods you are able to cook on the grill. The infrared burner also provides traditional sear lines on food, for the authentic grill experience.



**BGC-GP**

**71410**

**Grill Surface Griddle Plate**

Made of commercial quality plated stainless steel that insures a level cooking surface and even heat distribution, the DCS Grill Griddle Plate allows you to cook delicate items on your Grill with ease.

# SIDEBURNERS



## Sideburners



### **BGC131-BI**

71134 / 71135

Single Sideburner, Built-In

H10<sup>5</sup>/<sub>8</sub>" x W14<sup>9</sup>/<sub>16</sub>" x D16<sup>1</sup>/<sub>16</sub>"

H10<sup>1</sup>/<sub>8</sub>" x W12<sup>1</sup>/<sub>8</sub>" x D12"



### **BGC132-BI**

71136 / 71137

Double Sideburner, Built-In

H10<sup>5</sup>/<sub>8</sub>" x W14<sup>9</sup>/<sub>16</sub>" x D26<sup>5</sup>/<sub>8</sub>"

H10<sup>1</sup>/<sub>8</sub>" x W12<sup>1</sup>/<sub>8</sub>" x D22<sup>3</sup>/<sub>4</sub>"

### PRODUCT

SKU (NATURAL / LP)

TYPE OF APPLIANCE

Product Dimensions

Cut-out Dimensions (proud installation)



BUILDING  
YOUR ULTIMATE  
OUTDOOR KITCHEN

# DESIGNED TO FIT

Create a coherent, considered space with appliances that are designed to match and work together seamlessly.





The grill is only part of the ultimate outdoor kitchen set up. The space you have, how you want to entertain, and your expectations around performance will all play a role in how you make your outdoors outstanding.

#### **Series Level**

What level of performance do you require from your DCS grill?

#### **Size**

How much space do you have for your outdoor kitchen? This will impact both the size of grill you choose, and the number and sizes of storage and ancillary appliances.

#### **Installation**

Built-in or freestanding? Built-in creates a permanent and premium outdoor kitchen while a freestanding grill on cart gives you flexibility.

# OUTDOOR STORAGE





**Access Drawers**

**PRODUCT**

**SKU**

**TYPE OF APPLIANCE**

**Product Dimensions**

**Cut-out Dimensions (proud installation)**



**ADR2-48**

**71147**

**48" Access Drawers, Built-In**

**H21<sup>7</sup>/<sub>8</sub>" x W47<sup>15</sup>/<sub>16</sub>" x D25<sup>1</sup>/<sub>2</sub>"**

**H20" x W46" x D24"**

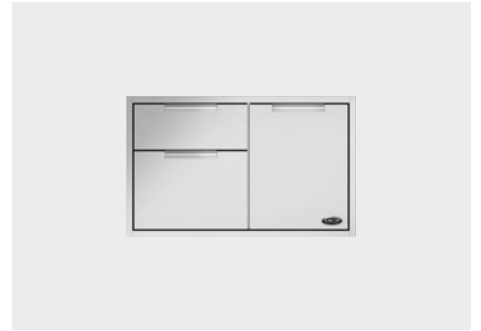

**ADR2-36**

**71148**

**36" Access Drawers, Built-In**

**H21<sup>7</sup>/<sub>8</sub>" x W35<sup>15</sup>/<sub>16</sub>" x D25<sup>1</sup>/<sub>2</sub>"**

**H20" x W34" x D24"**

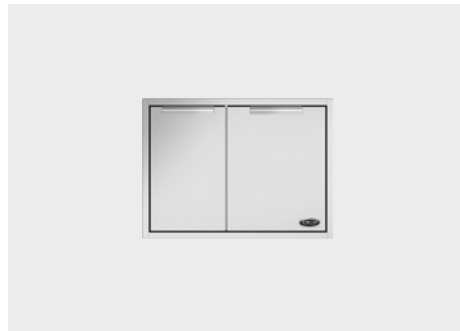

**ADR2-30**

**71149**

**30" Access Drawers, Built-In**

**H21<sup>7</sup>/<sub>8</sub>" x W30" x D25<sup>1</sup>/<sub>2</sub>"**

**H20" x W28" x D24"**

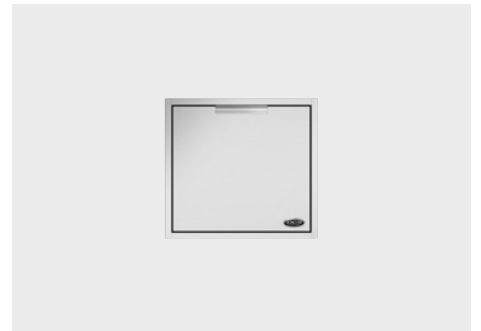

**ADR2-24**

**71150**

**24" Access Drawers, Built-In**

**H21<sup>7</sup>/<sub>8</sub>" x W24" x D25<sup>1</sup>/<sub>2</sub>"**

**H20" x W22" x D24"**

**Access Doors and Dry Pantry**

**PRODUCT**

**SKU**

**TYPE OF APPLIANCE**

**Product Dimensions**

**Cut-out Dimensions (proud installation)**

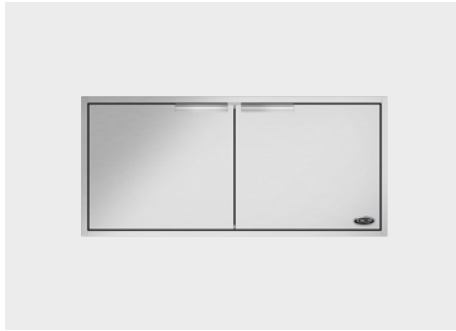

**ADN1-20X48**

**71151**

**48" Access Doors, Built-In**

**H21<sup>7</sup>/<sub>8</sub>" x W47<sup>15</sup>/<sub>16</sub>" x D6<sup>1</sup>/<sub>4</sub>"**

**H20" x W46"**



**ADN1-20X36**

**71152**

**36" Access Doors, Built-In**

**H21<sup>7</sup>/<sub>8</sub>" x W35<sup>15</sup>/<sub>16</sub>" x D6<sup>1</sup>/<sub>4</sub>"**

**H20" x W34"**



**ADN1-20X30**

**71153**

**30" Access Doors, Built-In**

**H21<sup>7</sup>/<sub>8</sub>" x W30" x D6<sup>1</sup>/<sub>4</sub>"**

**H20" x W28"**



**ADN1-20X24**

**71154**

**24" Access Doors, Built-In**

**H21<sup>7</sup>/<sub>8</sub>" x W24" x D6<sup>1</sup>/<sub>4</sub>"**

**H20" x W22"**



**DPI-42**

**71159**

**42" Dry Pantry**

**H30<sup>1</sup>/<sub>2</sub>" x W42" x D25<sup>1</sup>/<sub>16</sub>"**

**H29<sup>3</sup>/<sub>16</sub>" x W40<sup>7</sup>/<sub>16</sub>" x D24<sup>1</sup>/<sub>16</sub>"**

**Tower Drawers and Beverage Chiller**

**PRODUCT**

**SKU**

**TYPE OF APPLIANCE**

**Product Dimensions**

**Cut-out Dimensions (proud installation)**



**TDS1-20**

**71155**

20" Tower Drawer, Single

H9<sup>5</sup>/<sub>8</sub>" x W20<sup>5</sup>/<sub>16</sub>" x D25"

H8<sup>3</sup>/<sub>16</sub>" x W18<sup>7</sup>/<sub>16</sub>" x D24"



**TDD1-20**

**71156**

20" Tower Drawer, Double

H21<sup>1</sup>/<sub>8</sub>" x W20<sup>5</sup>/<sub>16</sub>" x D25"

H20<sup>1</sup>/<sub>16</sub>" x W18<sup>7</sup>/<sub>16</sub>" x D24"



**TDT1-20**

**71157**

20" Tower Drawer, Triple

H29<sup>1</sup>/<sub>8</sub>" x W20<sup>5</sup>/<sub>16</sub>" x D25"

H28" x W18<sup>7</sup>/<sub>16</sub>" x D24"



**TB1-20**

**71158**

20" Double Trash/Recycle Bin

H29<sup>1</sup>/<sub>8</sub>" x W20<sup>5</sup>/<sub>16</sub>" x D25"

H28" x W18<sup>7</sup>/<sub>16</sub>" x D24"



**BC25**

**71034**

25" Beverage Chiller/Sink

H12<sup>1</sup>/<sub>16</sub>" x W26<sup>3</sup>/<sub>16</sub>" x D21<sup>1</sup>/<sub>16</sub>"

W24<sup>3</sup>/<sub>16</sub>" x D21<sup>1</sup>/<sub>16</sub>"



**BC-BTTLEAC-25**

**71036**

Beverage Chiller Bottle Holder Accessory Front

H10<sup>3</sup>/<sub>16</sub>" x W25<sup>1</sup>/<sub>16</sub>" x D6<sup>3</sup>/<sub>16</sub>"

# REFRIGERATION



**Outdoor Refrigeration**

**PRODUCT**

**SKU (LEFT HINGE / RIGHT HINGE)**

**TYPE OF APPLIANCE**

**Product Dimensions**

**Cut-out Dimensions (proud installation)**



**RF24LE3 (Shown), RF24RE3**

**24483 / 71145**

**24" Outdoor Refrigerator**

**H33 3/4" - 34 3/4" x W23 7/8" x D23 23/32"**

**H34 1/2" x W24"**



**RF24DE3**

**71144**

**24" Double Refrigerator Drawers**

**H33 3/4" - 34 3/4" x W23 7/8" x D23 23/32"**

**H34 1/2" x W24"**



**RF24TL1 (Shown), RF24TR1**

**24479 / 71146**

**24" Outdoor Beer Dispenser — Single Tap**

**H33 3/4" - 34 3/4" x W23 7/8" x D23 23/32"**

**H34 1/2" x W24"**



**RF24BTL1 (Shown), RF24BTR1**

**24481 / 24480**

**24" Outdoor Beer Dispenser — Dual Tap**

**H33 3/4" - 34 3/4" x W23 7/8" x D23 23/32"**

**H34 1/2" x W24"**



**RF15IL1 (Shown), RF15IR1**

**24807 / 24806**

**15" Outdoor Clear Ice Maker**

**H34 1/4" x W15" x D21 1/2"**

**H34 1/2" x W15"**

# HEATING



**Built-In Patio Heater, Warming Drawer and Insulated Jacket**

**PRODUCT**

**SKU**

**TYPE OF APPLIANCE**

**Product Dimensions**

**Cut-out Dimensions (proud installation)**



**DRH-48N**

**70034**

**Built-In Patio Heater**

**H10 ¼" x W48" x D7 ¾"**



**WD1-30-SSOD**

**71142**

**30" Outdoor Warming Drawer**

**H16" x W30" x D26 ½"**

**H14 ¾" x W28 ¾" x D24 ¾"**



**BGB30-IJS**

**70859**

**30" Insulated Jacket**

**H11 ½" x W34 ¾" x D23 ¾"**

**H11 ½" x W34 ¾" x D23 ¾"**



**BGA36-IJS**

**70167**

**36" Insulated Jacket**

**H11 ½" x W40 ¾" x D23 ¾"**

**H11 ½" x W40 ½" x D23 ¾"**

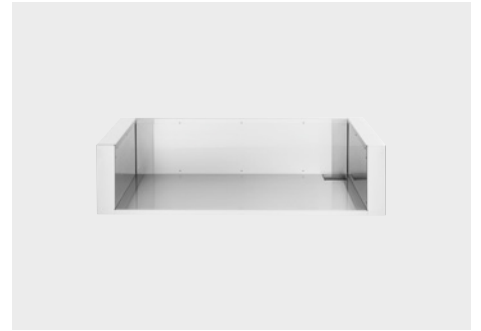

**BGA42-IJS**

**71335**

**42" Insulated Jacket**

**H11 ½" x W47 ¾" x D23 ¾"**

**H11 ½" x W48" x D23 ¾"**

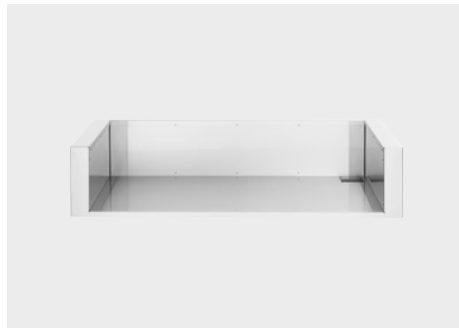

**BGA48-IJS**

**70172**

**48" Insulated Jacket**

**H11 ½" x W51 ½" x D23 ¾"**

**H11 ½" x W51 ½" x D23 ¾"**

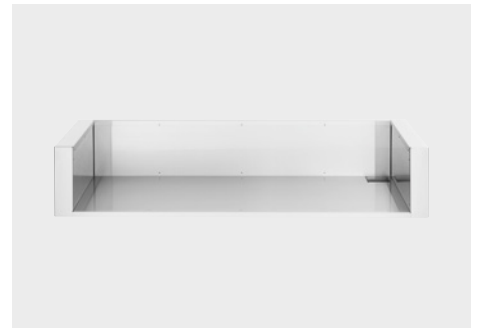

**BGA54-IJS**

**71334**

**54" Insulated Jacket**

**H11 ½" x W59 ¾" x D23 ¾"**

**H11 ½" x W60" x D23 ¾"**

# CARTS AND ACCESSORIES





**Carts and Side Shelves**

PRODUCT

SKU

TYPE OF APPLIANCE

Product Dimensions



**CSS-30**

**71320**

30" CSS Grill Cart

H35 3/4" x W30" x D25 1/2"



**CAD1-30**

**71131**

30" CAD Grill Cart

H35 1/2" x W30" x D25 1/2"



**CAD1-36E**

**71407**

36" Series 9 Evolution CAD Cart

H35 1/2" x W35 1/8" x D25 1/2"



**CAD1-48E**

**71408**

48" Series 9 Evolution CAD Cart

H35 1/2" x W47 1/8" x D25 1/2"

PRODUCT

SKU

TYPE OF ACCESSORY

DESCRIPTION



**CAD1-SK**

**71189**

CAD Cart Side Shelf Kit

Attached to your Freestanding Cart, 24" heavy-duty, stainless steel side shelf kits offer a sturdy expansive workspace that folds down when not in use.



**CSS-SK**

**71323**

CSS Grill Cart Side Shelf

Attached to your Freestanding Cart, 20" heavy-duty stainless steel side shelf kits offer a sturdy expansive workspace that folds down when not in use.

## Outdoor Cutouts - Non-combustible Surrounds

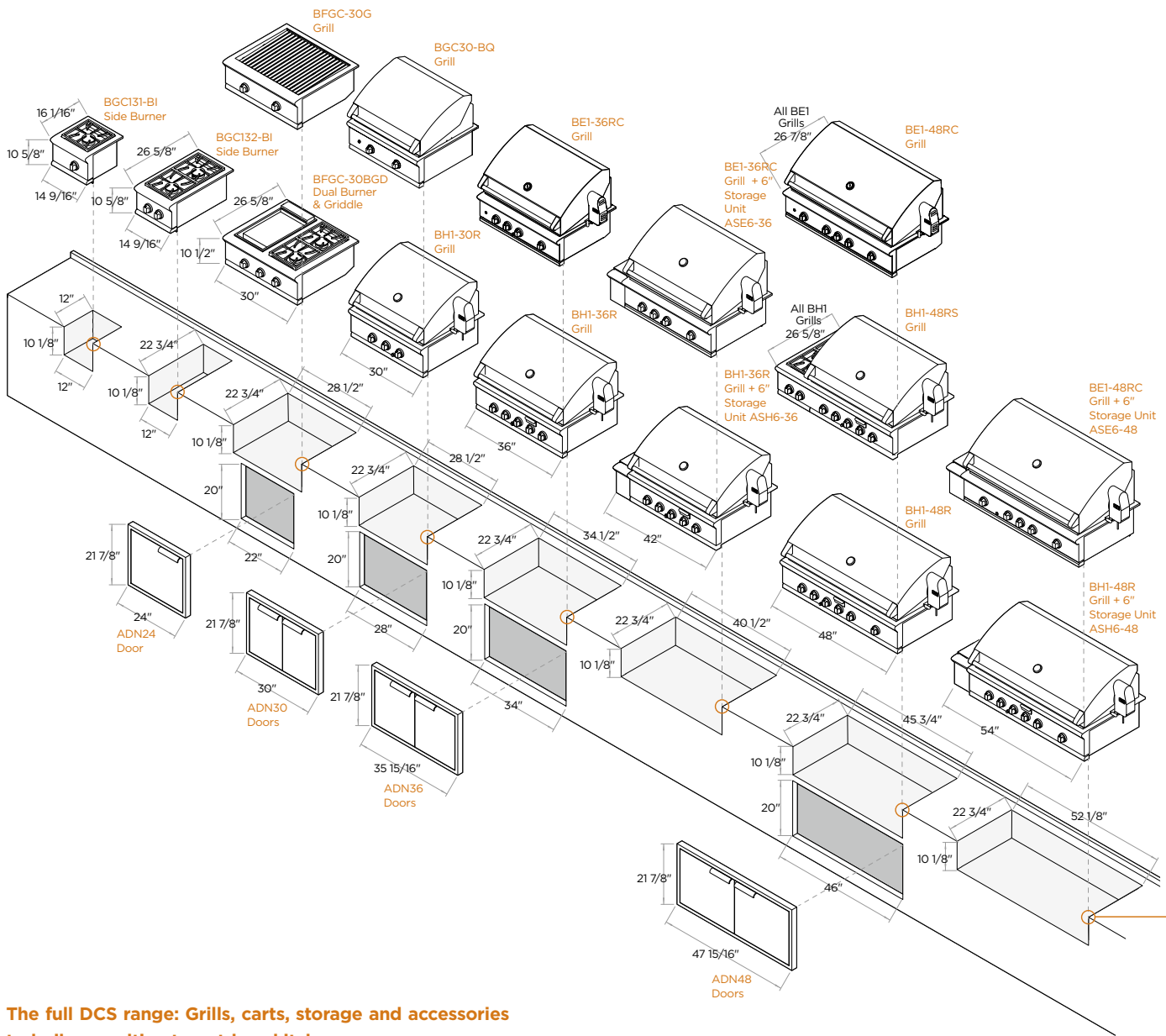
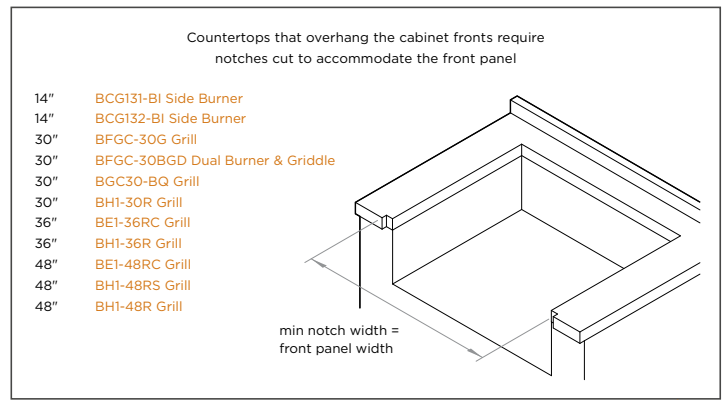

The full DCS range: Grills, carts, storage and accessories to build your ultimate outdoor kitchen.

For detailed product information visit [dcsappliances.com](http://dcsappliances.com)

**Outdoor Cutouts - Combustible Surrounds**

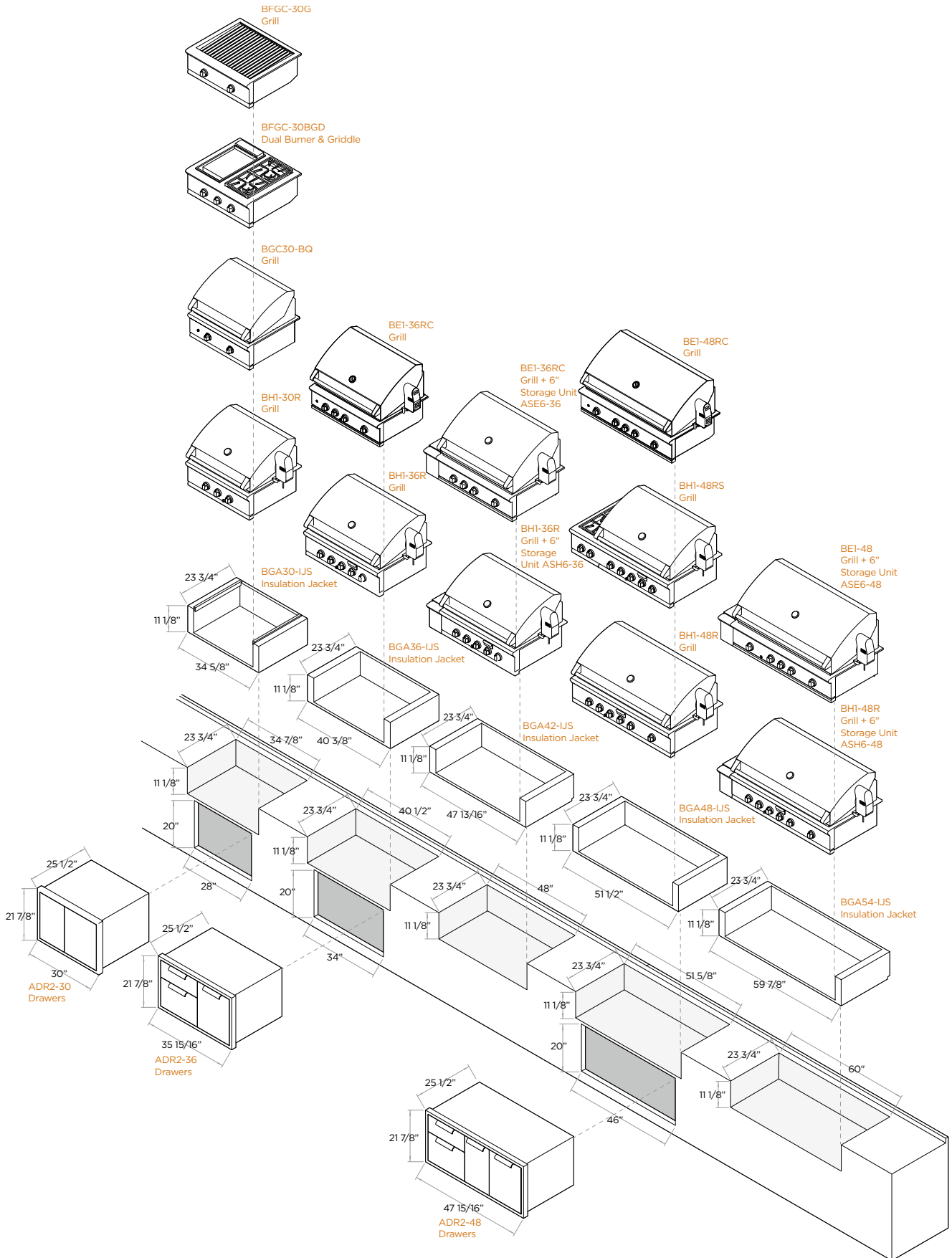

**Outdoor Cutouts - Storage Accessories**

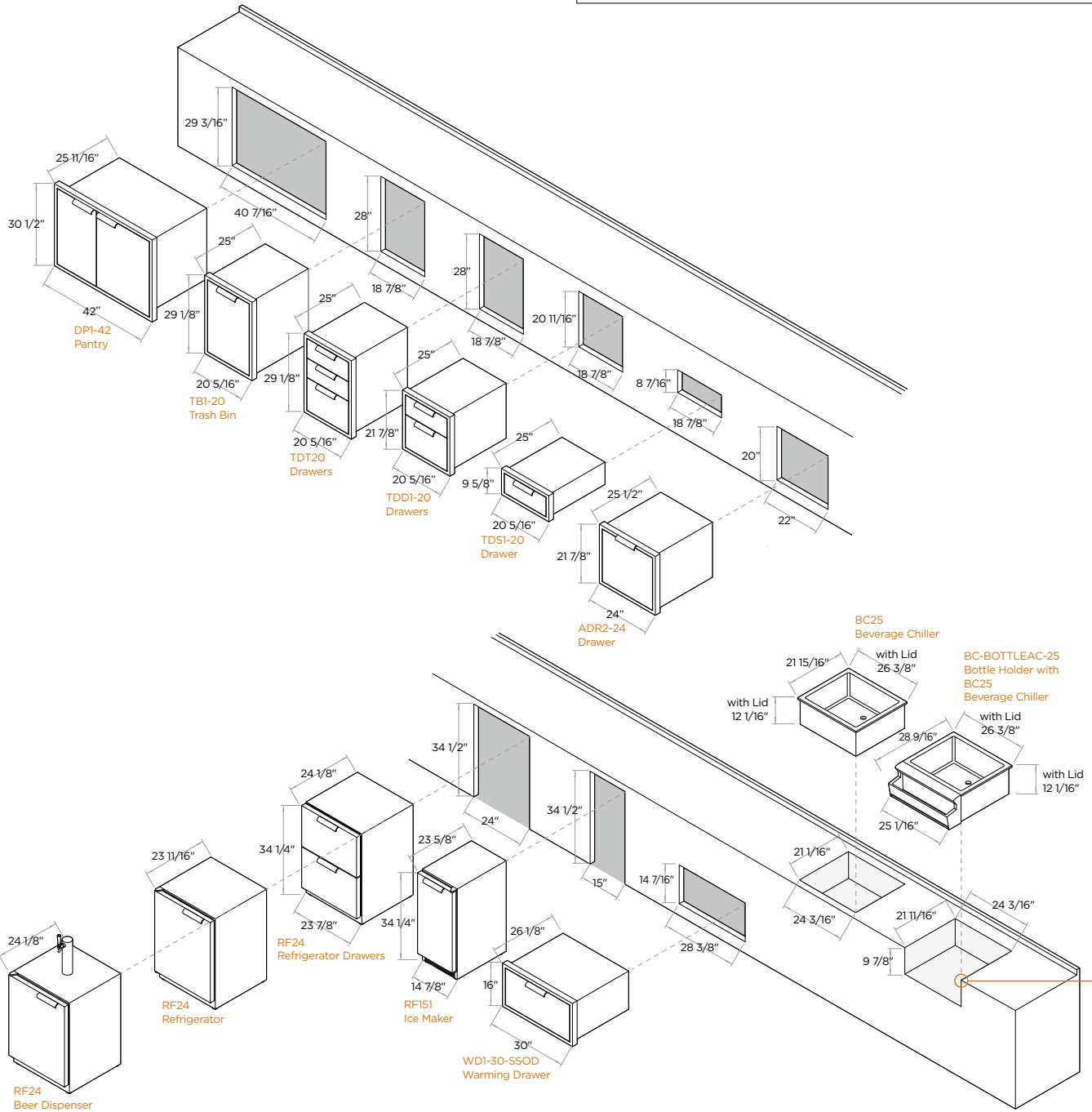
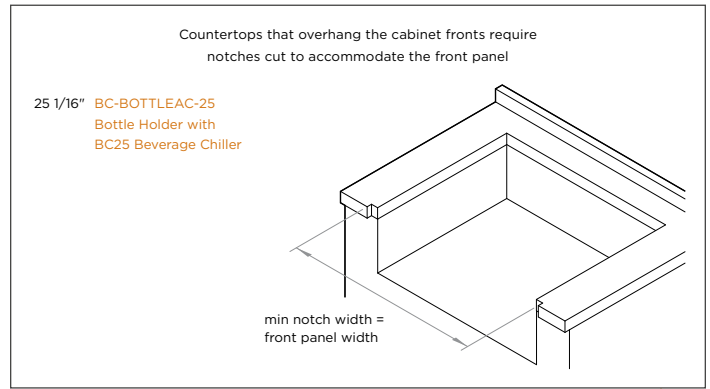



## Customer Care

### A Peace-of-mind Purchase

Call 24 hours a Day, 7 Days a Week

Fisher & Paykel has a 24-hour toll-free service that allows you to speak directly to a Customer Care Representative about any questions you might have regarding your DCS products. Our Customer Care Representatives can offer advice on which appliance will best suit your needs and provide extensive information regarding on how to use your current Fisher & Paykel and DCS products. We can also advise on installations, schedule service with our Factory Service team (if available) and tell you where your nearest Authorized Service Center can be found. Nobody is better qualified to install, service, and repair your Fisher & Paykel and DCS household appliances than our network of specifically trained service technicians.

Email us at [customercare@fisherpaykel.com](mailto:customercare@fisherpaykel.com) or call 24/7

1 - 888 - 936 - 7872

### Factory Service in Your Area

Assistance & Complete Servicing

Factory Service is available in most metropolitan areas. Please visit [dcsappliances.com/customersupport](http://dcsappliances.com/customersupport) or call 1-888-936-7872 for current coverage. We will recommend one of our Authorized Service Companies for areas where Factory Service is not available.

### Easy Online Scheduling

- Go to our website at [dcsappliances.com](http://dcsappliances.com)
- Click "Customer Care" from the top menu
- Click "Service My Product" from the options available
- Enter your zip code on the right side of the page

### Factory Service Advantages

- 12 months part and labor warranty on all repairs
- Full stock of parts on vehicles
- Expert assistance on DCS and Fisher & Paykel products
- Before and after sales service
- Product education at the completion of service
- 24/7 booking service

COVER IMAGE

Designer: Ginny Capo

Builder: Discola Contracting

Image: Dan Smith





[dcsappliances.com](http://dcsappliances.com)

