

FLEX 50BY

BAY FIREPLACE



Clean Burning

Fueled by clean burning
e-NRG bioethanol

Single Room Application

Bay fireplaces feature three open
sides - view the flame from the front
and both sides.

Global Compliance

These models comply with
existing standards in the USA,
Europe, UK and Australia.
UL Listed, EN 16647 BSI
Certified, ACCC Safety
Mandate compliant.

Toughened Safety Screen

Your Flex Fireplace features
toughened glass to stabilise
the flame in windy conditions
and provide an additional layer
of safety and comfort. The
Integrated windscreen sits flush
behind the frame.

Decorative Side Box

When a decorative box is
added, the panel between the
standard fire and the decorative
box is glass.

Luxurious Finish

Available in a timeless black finish, Flex
Fireplaces come with stainless steel
burners and black glass charcoal.

Built to Last a Lifetime

Zinc sealed steel construction powder
coated with super hi-temp black paint
prevents rusting so all fireplaces can
be used both indoors or outdoors.

Decorative Steel Log Sets (sold separately)

EcoSmart Fire offers non-combustible logs as an
optional, eye-catching accessory for models with the
decorative side box. Made from stainless steel with a
patina finish, they are available in different finishes.

**Decorative logs must NOT be placed directly over an
open flame. They are designed to sit near heat but not
over flames.*

Zero Clearance

Self-contained, zero clearance construction allows your Flex
fireplace to be framed into wood or metal studs, providing
installation freedom and flexibility for builders, architects,
interior designers, landscapers and homeowners.

OPTIONAL ACCESSORIES



Decorative
Steel Logs

BAY FIREPLACES

| | |
|--------------------|---|
| Application | Indoor & Outdoor |
| Materials | Mild Steel (Zinc Sealed), Toughened Glass, Stainless Steel & Black Glass Charcoal as Decorative Media |
| Colours | Black Firebox, Stainless Steel Burner/s |
| Fuel Type | e-NRG Bioethanol |

FLEX50

ESF.1.FX.50BY

| | |
|---|---|
| Weight | 71.8kg [158lbs] (Incl. burner/s, glass charcoal, glass) |
| Burner | XL900 x 1 |
| Volume Capacity | 9 Litres [2.4 Gallons] |
| Heats on Average (when used indoors) | Over 60 square metres [645 square feet] |
| Burn Time | 8 - 13 hours (approx) |
| Minimum Room Size | 110 cubic metres [3884 cubic feet] per fireplace. |
| Minimum Wall Length | 1,475mm [58in] |

ESF.1.FX.50BY.BXL

ESF.1.FX.50BY.BXR

| | |
|---|---|
| Weight | 76.2kg [167.6lbs] (Incl. burner/s, glass charcoal, glass) |
| Burner | XL500 x 1 |
| Volume Capacity | 5 Litres [1.3 Gallons] |
| Heats on Average (when used indoors) | Over 40 square metres [430.6 square feet] |
| Burn Time | 10 - 13 hours (approx) |
| Minimum Room Size | 80 cubic metres [2825 cubic feet] per fireplace. |
| Minimum Wall Length | 1,475mm [58in] |

Physical model dimensions should be verified against cut out dimensions BEFORE installation begins to confirm tolerances align.

These values are indicative only and may vary depending on the model purchased, installation, and the seasonal resource used to manufacture e-NRG.

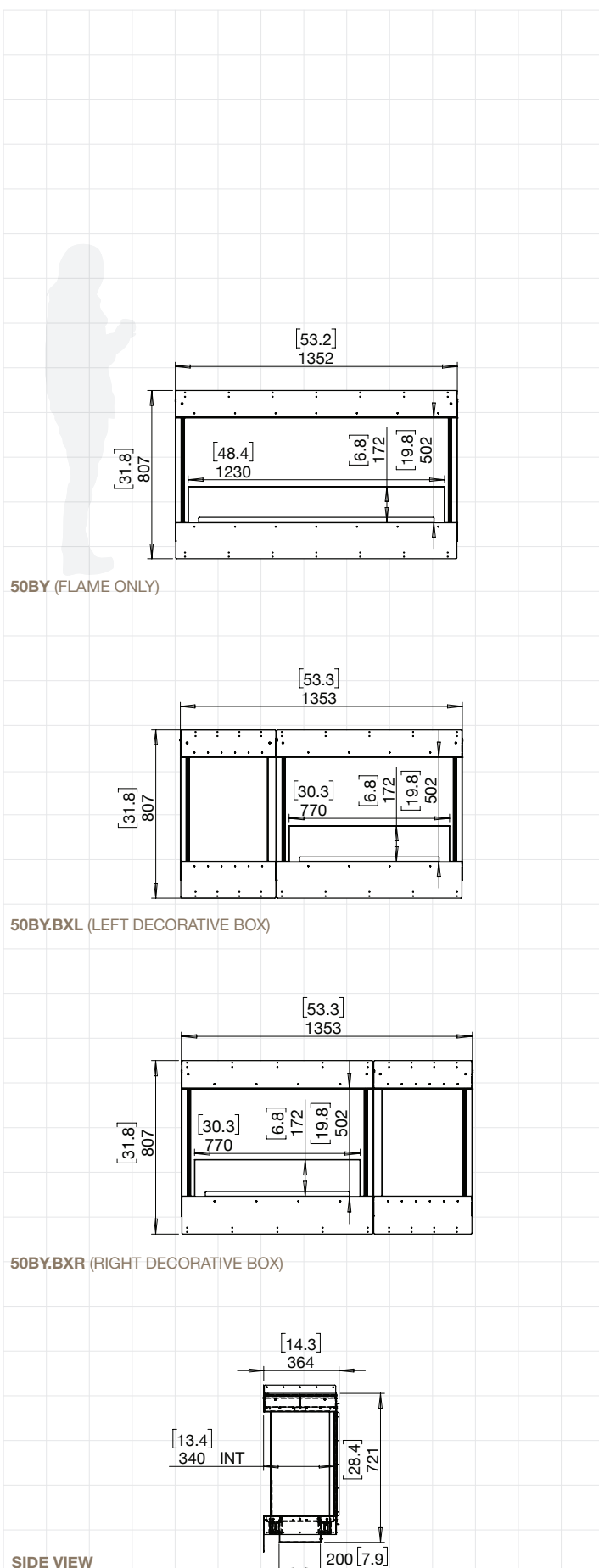

FOR MORE INFORMATION PLEASE REFERENCE THE CLEARANCE & INSTALLATION MANUAL

Disclaimer: All product specifications and data are subject to change without notice and believed to be correct at the time of publication. MAD Design Group (MDG), its affiliates, agents, and employees, and all persons acting on its or their behalf (collectively, "MAD Design Group"), disclaim any and all liability for any errors, inaccuracies or incompleteness contained herein or in any other disclosure relating to any product. MDG disclaims any and all liability arising out of the use or application of any product described herein or of any information provided herein to the maximum extent permitted by law. The product specifications do not expand or otherwise modify MDG's terms and conditions of purchase, including but not limited to the warranty expressed therein, which apply to these products. No license, express or implied, by estoppel or otherwise, to any intellectual property rights is granted by this document or by any conduct of MDG. Customers using or selling MDG products not expressly indicated for use in such applications do so entirely at their own risk and agree to fully indemnify MDG for any damages arising or resulting from such use or sale. Please contact authorised personnel from MDG to obtain written terms and conditions regarding products designed for such applications. Images are indicative only.

BAY INSTALLATIONS



FLEX68BY.BXL



FLEX104BY.BXL



FLEX122BY.BX2